

$100^{\circ}04'16''W - 101.87'$   
 $115^{\circ}04'50''W - 147.71'$   
 $115^{\circ}42'05''W - 53.85'$   
 $N40^{\circ}54'20''W - 110.00'$   
 $S68^{\circ}41'59''W - 48.89'$   
 $N00^{\circ}01'47''W - 154.36'$   
 $N40^{\circ}51'07''E - 44.13'$   
 $N00^{\circ}01'47''W - 118.53'$   
 $N79^{\circ}54'25''E - 32.05'$   
 $N70^{\circ}59'06''W - 29.55'$   
 $N94^{\circ}59'06''W - 113.14'$   
 $N51^{\circ}21'19''E - 115.36'$   
 $N00^{\circ}00'54''E - 115.00'$   
 $N39^{\circ}59'06''W - 91.58'$

Lot	Area	Area	Area	Area	Area
122	101.00	101.00	101.00	101.00	101.00
123	101.00	101.00	101.00	101.00	101.00
124	101.00	101.00	101.00	101.00	101.00
125	101.00	101.00	101.00	101.00	101.00
126	101.00	101.00	101.00	101.00	101.00
127	101.00	101.00	101.00	101.00	101.00
128	101.00	101.00	101.00	101.00	101.00
129	101.00	101.00	101.00	101.00	101.00
130	101.00	101.00	101.00	101.00	101.00
131	101.00	101.00	101.00	101.00	101.00
132	101.00	101.00	101.00	101.00	101.00
133	101.00	101.00	101.00	101.00	101.00
134	101.00	101.00	101.00	101.00	101.00
135	101.00	101.00	101.00	101.00	101.00
136	101.00	101.00	101.00	101.00	101.00
137	101.00	101.00	101.00	101.00	101.00
138	101.00	101.00	101.00	101.00	101.00
139	101.00	101.00	101.00	101.00	101.00
140	101.00	101.00	101.00	101.00	101.00
141	101.00	101.00	101.00	101.00	101.00
142	101.00	101.00	101.00	101.00	101.00
143	101.00	101.00	101.00	101.00	101.00
144	101.00	101.00	101.00	101.00	101.00
145	101.00	101.00	101.00	101.00	101.00
146	101.00	101.00	101.00	101.00	101.00
147	101.00	101.00	101.00	101.00	101.00
148	101.00	101.00	101.00	101.00	101.00
149	101.00	101.00	101.00	101.00	101.00
150	101.00	101.00	101.00	101.00	101.00
151	101.00	101.00	101.00	101.00	101.00
152	101.00	101.00	101.00	101.00	101.00
153	101.00	101.00	101.00	101.00	101.00
154	101.00	101.00	101.00	101.00	101.00
155	101.00	101.00	101.00	101.00	101.00
156	101.00	101.00	101.00	101.00	101.00
157	101.00	101.00	101.00	101.00	101.00
158	101.00	101.00	101.00	101.00	101.00

# CASTLEWOOD ADDITION - SECTION III

1) See Exhibit A - List of Lots  
 Exhibit B - Map

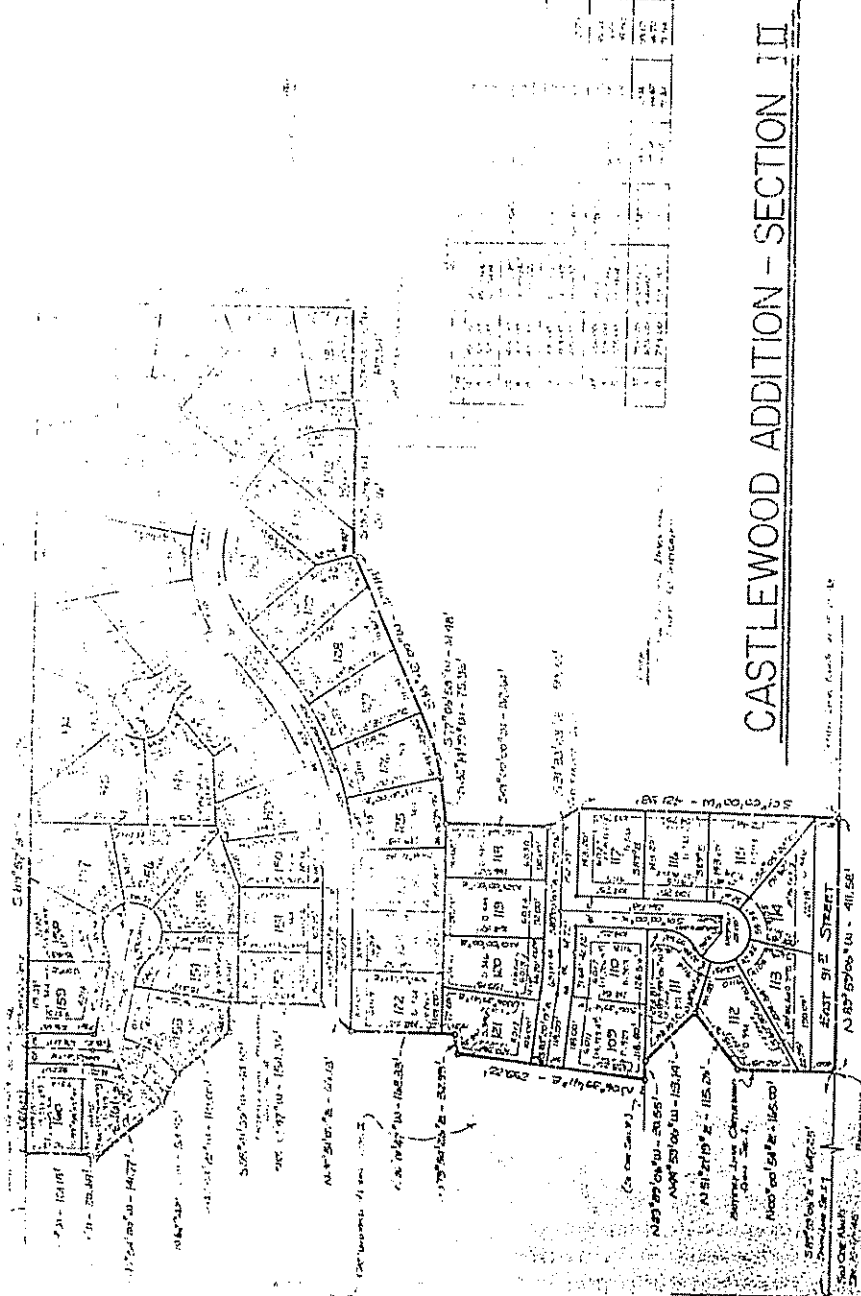

# CASTLEWOOD ADDITION - SECTION II

Section II of the Castlewood Addition, containing lots 112 through 121, is shown on the attached plan. The lots are bounded on the north by East 9th Street, on the east by East 10th Street, on the south by East 11th Street, and on the west by the boundary of Section I. The lots are to be used for residential purposes.

  
 J. J. SMITH  
 Surveyor



## CASTLEWOOD ADDITION SECTION II

The lots shown on this plan are to be used for residential purposes. The lots are bounded on the north by East 9th Street, on the east by East 10th Street, on the south by East 11th Street, and on the west by the boundary of Section I. The lots are to be used for residential purposes.

Feb 3rd 1917  
 J. J. Smith

76 0 28  
 Length  
 77-007651